



## INSTALLATION INSTRUCTIONS

# Common Sense® Cutting Edge System

### PARTS INCLUDED

COMMON SENSE® BLADE (10.0' Set-up shown)

Blade widths available to fit 10.0', 11.0' plow.

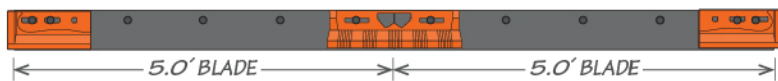

5.0' BLADE

6.0' BLADE



5' OR 6' BLADE SECTIONS



XTENDOR® CAST GUARD  
(Left and Right)



XTENDOR® UNIVERSAL



PLOW BOLT KIT  
INCLUDED

### IMPORTANT!

The moldboard mounting surface must be clean of all foreign material prior to installing new blades and hardware to avoid issues with bolt loosening while in service.

- ◆ For torque recommendation, please refer to SAE J1701
- ◆ Re-torque hardware after the first 10 plow hours

### Step 1

Clear moldboard of all foreign material before mounting Common Sense® blade sections with the 2" plow bolts in the provided mounting hardware kit. Hand tighten. Leave the outside bolt holes empty for Step 2.

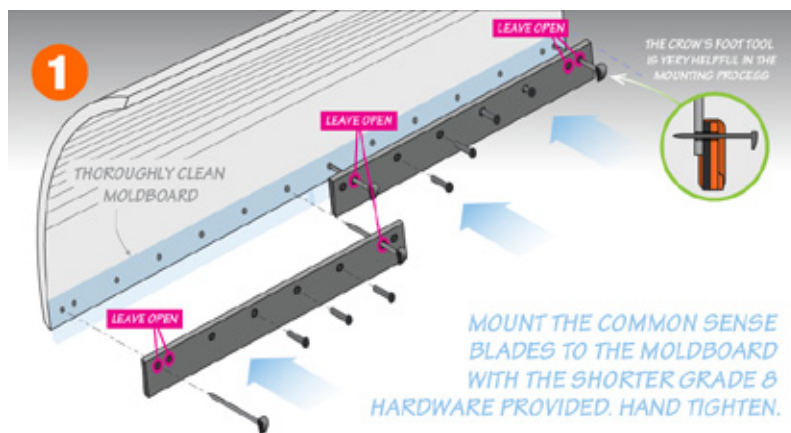

### Step 2

Install drivers- and passengers-side Xtendor® CastGuard curb guards with the 2.5" carriage bolts. Hand tighten. Leave the four bolt holes in the center of the plow – where the left and right blades meet – empty for Step 3.

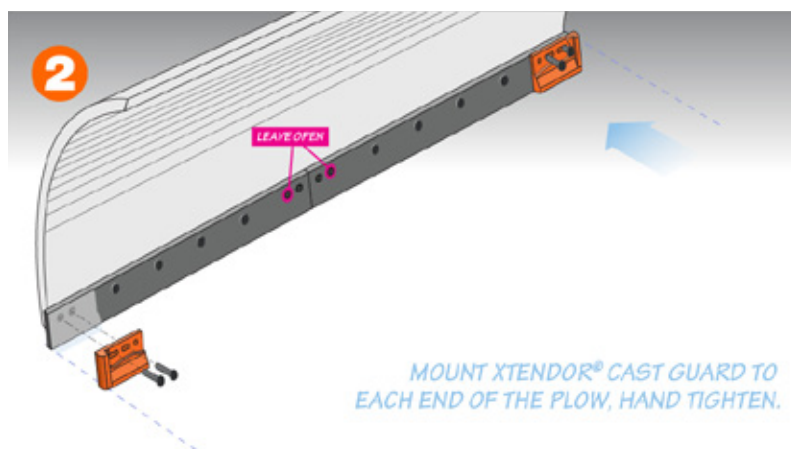

### Step 3

Install the Xtendor® Universal in the center where the blades meet with 2.5" carriage bolts included. Hand tighten.

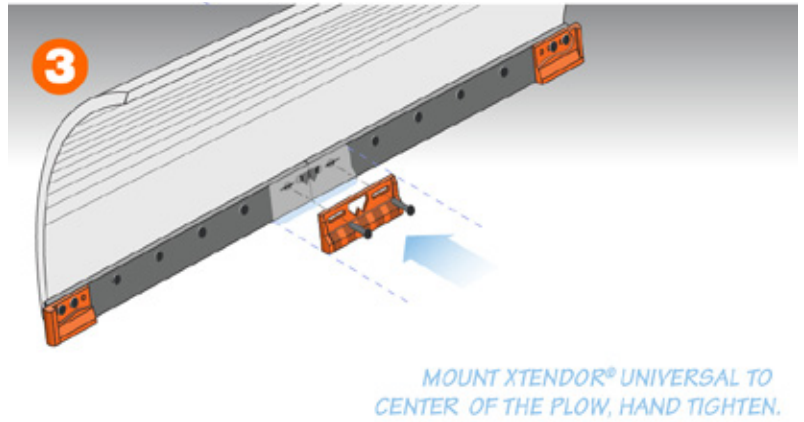

### Step 4

Set entire assembly on ground to ensure it's level.

Fully tighten all bolts. For torque specification, please refer to SAE J1701.

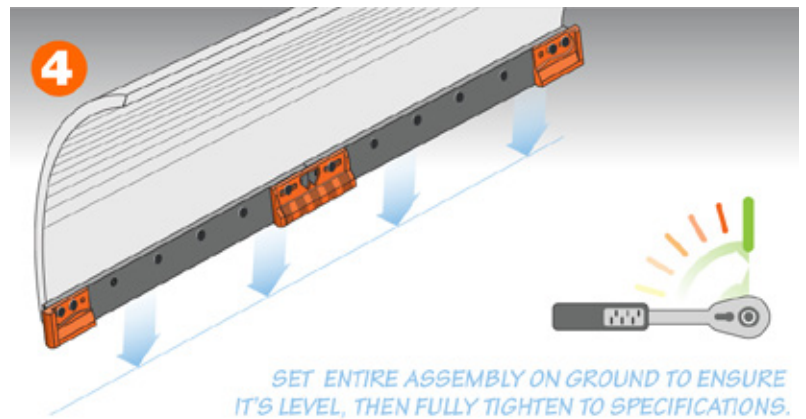

Re-torque hardware after the first 10 plow hours