

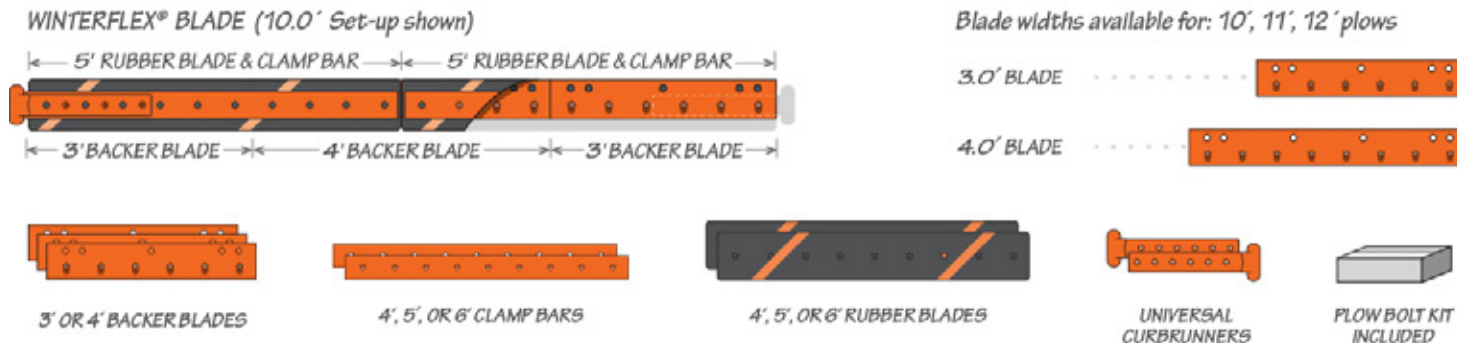

## INSTALLATION INSTRUCTIONS

# WinterFLEX® Cutting Edge System

### PARTS INCLUDED



### IMPORTANT!

The moldboard mounting surface must be clean of all foreign material prior to installing new blades and hardware to avoid issues with bolt loosening while in service.

- ◆ For torque recommendation, please refer to SAE J1701
- ◆ Re-torque hardware after the first 10 plow hours

### Step 1

Thoroughly clean moldboard, then mount WinterFLEX® Backer Blades to the plow using 3" Grade 8 plow bolts through the upper row of holes. Hand tighten.

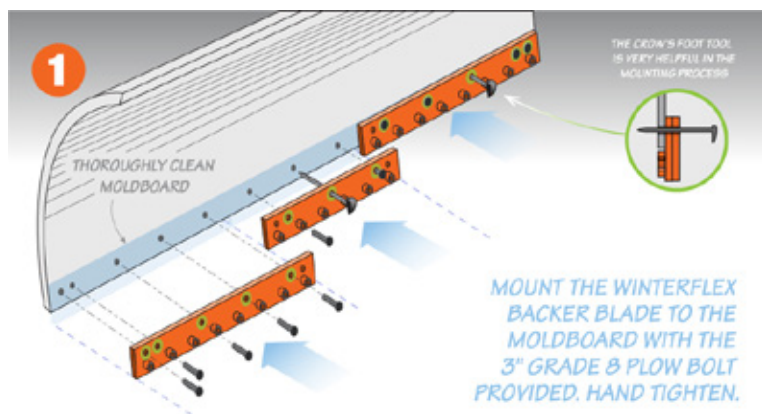

### Step 2

Mount WinterFLEX® Rubber Blade to the backer blade by sliding the blade over the bushings on the lower portion of the backer blade.

Align the holes in the WinterFLEX® Clamp Bar over the bushings and mount using 4" Grade 8 plow bolts. Hand tighten. Leave three holes on either end of the plow open for Step 3.

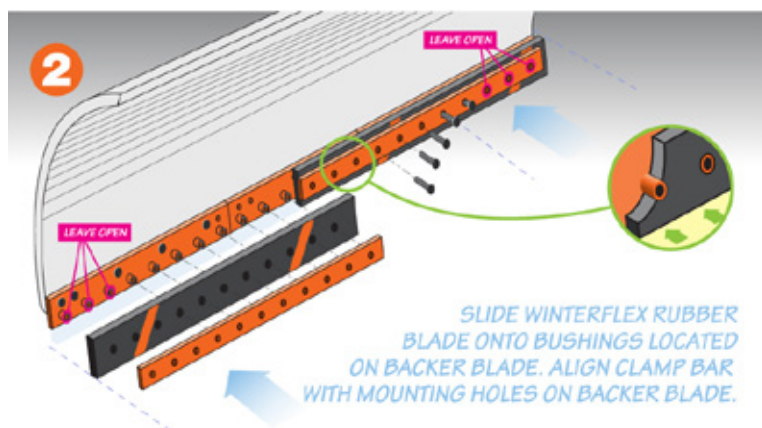

### Step 3

Install a Universal CurbRunner® on each end of the plow with included 4.5" Grade 8 plow bolts. Hand tighten.

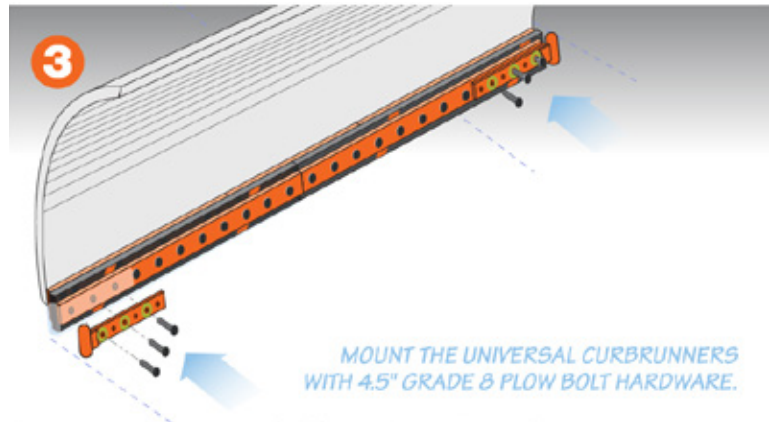

### Step 4

Fully tighten all bolts. For torque specification, please refer to SAE J1701.



Re-torque hardware after the first 10 plow hours